

## All Plywood Construction Option (APC)

The All Plywood Construction Option features:

- ½" plywood cabinet sides, floors, and tops
- ¾" plywood shelves with edge banding
- ⅛" plywood captured back
- ½" plywood inset toe kick
- ½" plywood corner blocks (excluding BER, BSS, CAR, CBS, CSB cabinets)

### SPECIFICATIONS

- For individual cabinets or entire design
- Available with Matching Interior Cabinet Option (where available)
- Matching Interior cabinetry features ¾" plywood shelves finished to match cabinet exterior
- Toe kick support blocks are not plywood
- All Plywood Construction refers to the cabinet box components and shelving as detailed above (certain parts and accessories are not available with this construction option). Plywood can consist of a combination of veneer and furniture board layers to achieve superior product stability and finish quality. Plywood components meet the ANSI/HPVA hardwood and decorative plywood standards ([www.hpva.org](http://www.hpva.org)).

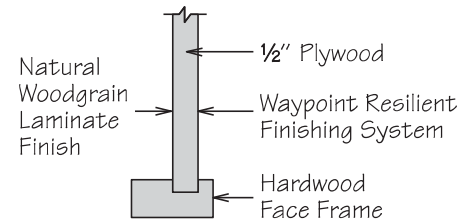

## Furniture Ends Option (FE)

The Furniture Ends Option converts both side panels to ¾" plywood sides.

### SPECIFICATIONS

- Exterior sides are finished to match specific cabinet color
- For individual cabinets
- Not available for BEA24 FH Base End Angle or WEA12 Wall End Angle cabinets
- BEA12 FH will have only the 12" side converted
- End panels are not required for exposed ends of cabinets with the Furniture Ends Option or for installation of Decorator Matching Doors
- Cabinet Angle Molding CAM8 cannot be used with cabinets with the Furniture Ends Option
- Sink Front Return SFR (R/L) with the Furniture Ends Option will include a rabbetted front edge
- A seam will be visible between stacked cabinets as well as on 93" and 96" Tall cabinets (between the toe kick box and cabinet). Decorative molding is recommended in order to conceal this seam (e.g., BM8 WD Batten Molding or OGP8 Ogee Pilaster Molding).
- Plywood can consist of a combination of veneer and furniture board layers to achieve superior product stability and finish quality. Plywood components meet the ANSI/HPVA hardwood and decorative plywood standards ([www.hpva.org](http://www.hpva.org)).

